

COLLECTION INFO

AVAILABILITY:

in-stock, typically ships within 24-48 hours

AVAILABLE FINISHES:

BN = brushed nickel
PC = polished chrome

MATERIAL:

■ steel

DIAMETER & BRACKETS:

5/8"SQ: bracket required every 3-4 feet

STYLE:

Contemporary

SHIPPING & ADDITIONAL NOTES:

The collection's tube splice can be used to achieve longer spans - the required center bracket will help conceal the resulting seam.

ABBREVIATION KEY:

D = diameter
H = height
L = length
P = projection
W = width
ID = inside diameter
OD = outside diameter

SAMPLE SET-UPS:

Ball (finial)



Tri-Square (finial)



Plaza

Vesta's Plaza collection features a highly geometric aesthetic and is available in two contemporary finishes. Create a unique look for your next treatment with this stylish and affordable product group. All items are stocked in our warehouse and available for quick shipping.

COMPONENT SPOTLIGHT

Featured below is this collection's wall bracket. To install attach the wall plate (1) to the wall with the provided screws, then slide the bracket (2) over the plate. Slide the square tubing (3) through the bracket slots and finish the installation by tightening bracket screw (4) to lock tubing in place.

part: #164210

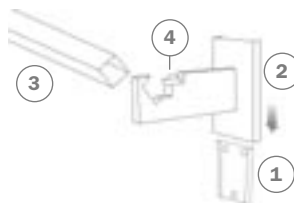

drapery hardware made easy!

- Innovative
- Functional
- Unique

800.638.3782
 sales@ivesta.com

Plaza collection

5/8" square
bracket required every 3' - 4'

Vesta Inc / 800.638.3782 - voice / 864.225.0228 - fax / www.ivesta.com

Availability: in-stock, typically ships within 24-48 hours | Available Finishes: BN, PC | Material: steel

FINIALS

{ IN-STOCK }
for quick shipping



A. Tri-Square

#164110
3/4"W, 2 1/2"L
*shown in BN

B. Rectangle

#164140
1 1/8"W, 3 1/4"L
*shown in PC

C. Combo

#164120
1"W, 3 1/16"L
*shown in PC

D. Ball

#164150
1 1/8"W, 2"L
*shown in BN

E. Cube

#164130
1 1/8"W, 2"L
*shown in PC

ACCESSORIES



End Cap
#164100
3/4"W, 9/16"L



Square Ring
w/insert & clip
#166410
1 1/16"ID, 1 9/16"OD



Flat Ring
w/insert
#206060
1 1/4"ID, 1 3/4"OD



Ring Clip
brass
#909110



BRACKETS



Wall Bracket short
#164210 - 1 3/4"W, 3"P



Wall Bracket long
#164220 - 1 3/4"W, 4 1/8"P



Double Wall Bracket
#164222 - 1 3/4"W, 2 1/2" & 6 3/8"P



Inside Mount
#164200 - 1 7/8"W, 2 1/16"L



Square Tubing
#164815 - 5/8"SQ - 59"L
#164820 - 5/8"SQ - 78"L
#164825 - 5/8"SQ - 98"L



Tube Splice
#164151
3/8"D, 2 1/16"L